

PART No: TWTL-2

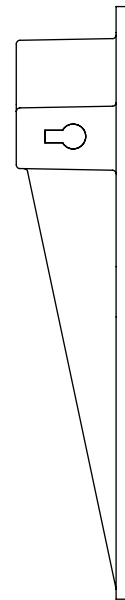

The Trailer Safety Lock is a simple, easy to use, effective safety solution. Specifically for trailers when the lorry cab/air hose has been removed. Once it is in position the product locks over the trailer hose connector preventing movement of the parked trailer. The warehouse operatives hold onto the key, so the trailer cannot be moved until it is safe to do so, minimising potential damage. It has a long life due to the high durability material that is used.

MATERIAL	PLASTIC
WEIGHT	130g
ESTIMATED LEADTIME	5 - 10 Working Days
LOCK TYPE	BARREL

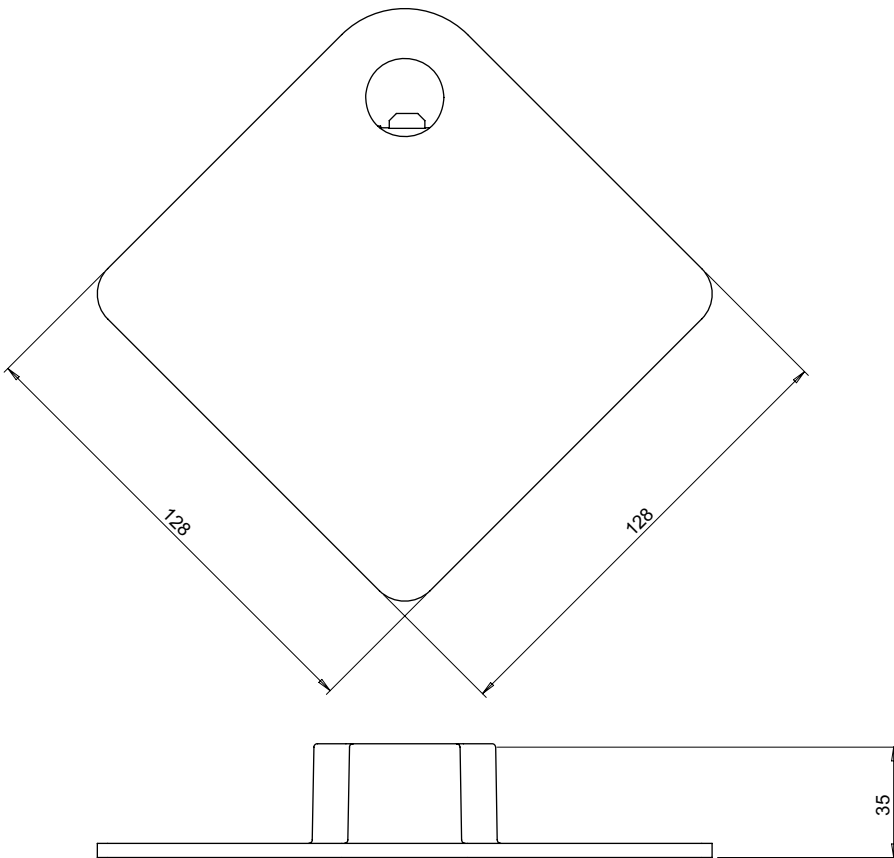

All dimensions shown are in millimetres and are intended for reference purposes only; exact product measurements may vary due to applied tolerances and methods of manufacture

