

PART No: TWSP-2436

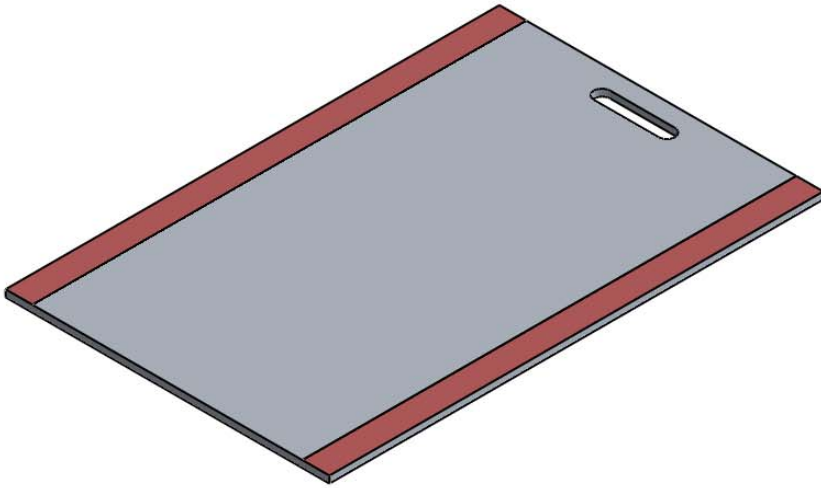

Thorworld Stabiliser Plates provide a solid platform for crane and excavator feet plus other equipment. They increase the contact surface area and spread the weight of the load. This reduces damage to paved areas and landscaping, providing a safer more stable footing.

MATERIAL	Heavy Duty Aluminium
WEIGHT	19 Kg
ESTIMATED LEADTIME	5 - 10 Workings Days
ADDITIONAL INFO	Finished with anti-slip tread plate. Built in Lifting Handle. Other sizes available on request.

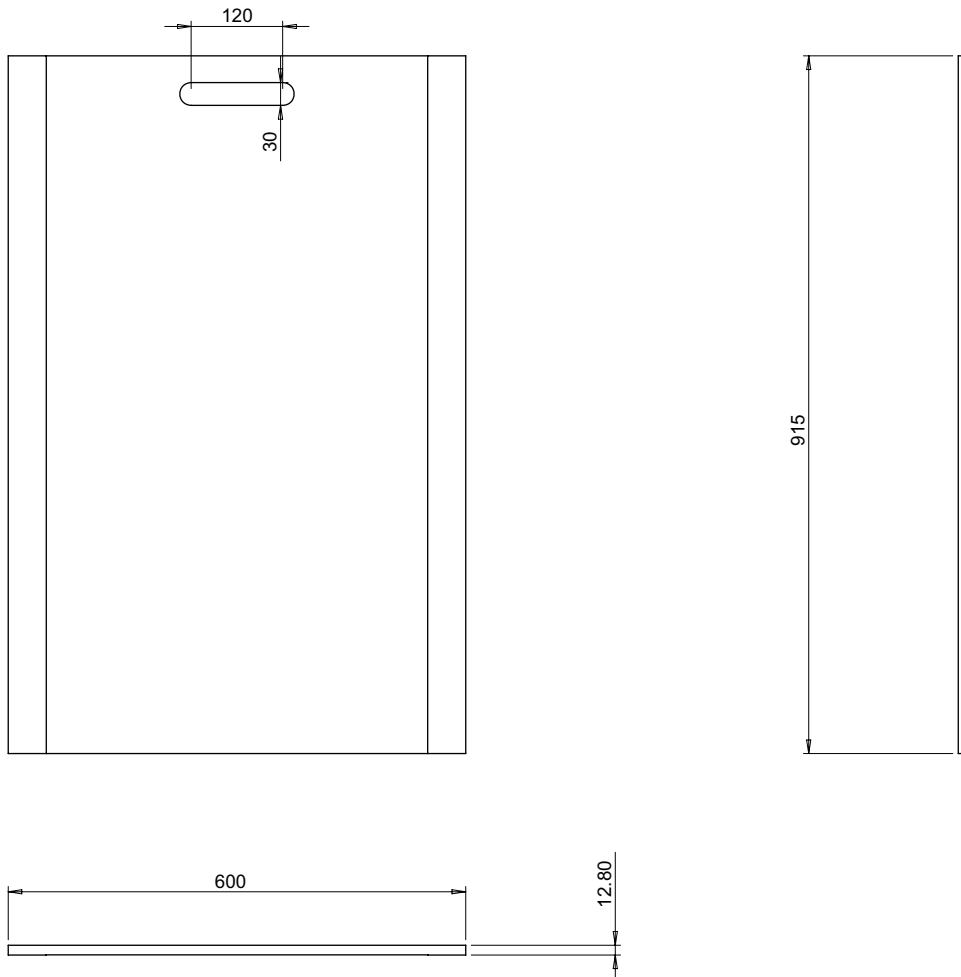

All dimensions shown are in millimetres and are intended for reference purposes only; exact product measurements may vary due to applied tolerances and methods of manufacture

